

Dear customer,

Thank you for choosing the high-grade bamboo parquet flooring bambeau® 3SF Solid plank with bevel. This product is available in oiled and lacquered forms.

That is why the instructions for care include tips for oiled and lacquered parquet.

Please note that laying parquet should always be the last work done in a building project. That way, there is less risk of the surface getting damaged.

We recommend full-surface gluing bambeau® 3SF Solid using a suitable parquet adhesive (according to DIN EN 14293). Full-surface gluing on heated screed constructions is possible after individual approval. You also have the option of floating-floor installation, as long as there is no underfloor heating, and the area of the room does not exceed approx. 36 m².

To retain the value and the high-grade finish of your parquet flooring, we ask you to read the following instructions carefully and follow them exactly.

Laying the flooring on heated screed constructions is only possible after individual approval.

The approval can be requested from Becker & Großgarten GmbH. Approval is granted solely through Becker & Großgarten GmbH on a project-specific basis.

VISUAL INSPECTION OF THE PACK CONTENTS AND THE FLOOR BOARDS BEFORE INSTALLATION

Please check the floor boards for defects and visible damage. We can only accept complaints made after installation if the defects were not visible (hidden). If you have any problems laying the flooring, you should contact your specialist retailer immediately.

SOME GENERAL POINTS TO NOTE BEFORE INSTALLATION

bambeau® 3SF Solid is not suitable for wet rooms, such as bathrooms, toilets, saunas or laundry rooms. The room where the parquet is to be laid must be dry. The relative humidity should always be between 50 and 65%. If necessary, check the humidity using a hygrometer. Lay the flooring at a room temperature of at least 15°C and at most 22°C. The ambient conditions should be kept constant after installation as well. Temperatures between 18°C and 22°C and a room humidity of between 50% and 65% are ideal. Constant ambient conditions prevent gaps from forming.

The parquet should be kept in the room where it will be laid in its original, unopened packaging for at least 48 hours before installation, to give it time to acclimatise. That way, the parquet material can adapt to the ambient conditions in the room. The packaging contents should be stored horizontally and flat side-by-side, and should not be opened until just before installation.

Please take into consideration that our 100% bamboo flooring board is a solid, three-ply parquet construction. Solid floors place greater demands on the floor layer. Generally, slight longitudinal cupping may occur with solid parquet constructions. In such cases it is essential to brace the floor rows together or to ballast them, in order to create an even and professional floor surface.

SUBFLOORS

bambeau® 3SF Solid is suitable for almost all subfloors except heated screeds. The surfaces must be level, free of cracks, permanently dry and clean.

The evenness of the floor must be checked with a level spirit. The permissible planarity tolerances are described in DIN 18 202. The values for stringent requirements must be adhered to.

The prefinished parquet element cannot be laid as a self-supporting floor on balconies!

The surface temperature of the subfloor should not be less than 15°C at the time of installation; the optimal room humidity is 60%. Do not ventilate during installation. Opened packs must be used up immediately.

Screeds

The moisture content of a screed depends on the type and its age!

If the screed is a permanently dry type which meets the test criteria of DIN 18356 Part 3.1, prepare the surface for parquet installation in line with the state-of-the-art (e.g. grind, brush, vacuum, prime, smooth). If levelling compounds or fillers are used, always make sure they are suitable for parquet. The equilibrium moisture content (EMC) of the different subfloors should not exceed the percentages given in the table below. Moisture should be measured using a **CM tester**, and logged. The percentages given are for a screed thickness of up to 45 mm.

Table of max. permissible EMCs of different subfloors:

Type of subfloor	Max. permissible EMC
Cement screed (3.4 – 3.8% by weight)	1.8 – 2.0% by CM
Heated cement screed	less than 1.8% by CM
Calcium sulphate screed (0.7 – 1.2% by weight)	0.3 – 0.5% by CM
Heated calcium sulphate screed	less than 0.3% by CM
Calcium sulphate flowing screed	less than 0.5% by CM
Heated calcium sulphate flowing screed	less than 0.3% by CM
Gypsum screed (0.7 – 1.2% by weight)	less than 0.5% by CM
Chipboard	9.0 +/- 3.0% by weight
Other subfloors	See comment on VOB/DIN 18 356 or consult your specialist retailer

FORMS OF INSTALLATION

Use elements from several packs at the same time to achieve the most uniform overall scheme in the parquet floor.

1 | Full-surface gluing using parquet adhesive

Always apply the adhesive with a notched trowel. It is important to follow the adhesive manufacturer's instructions. The quantity applied in particular should be adhered to exactly as directed by the adhesive manufacturer.

How much parquet adhesive you use depends on the condition of the subfloor: approx. 800 – 1,200 g/m².

Lay the parquet blocks lengthwise towards the main light source if at all possible. The first row of parquet is laid parallel to the wall with the groove to the wall, and any unevenness in the wall worked in. Use elements from several packs at the same time to achieve the most uniform overall scheme in the parquet floor.

Press the blocks into the adhesive bed and shove into place; tongue and groove by hand or with the aid of a pull bar. When fitting the parquet blocks, never hit the tongue directly with the hammer; always use a chock. The joints of the parquet blocks should be at least 10 cm apart. Expansion gaps in the subfloor must be carried through to the floor covering; this also goes for the joints in the door jamb area.

Choosing parquet adhesives: Due to their water content, dispersion adhesives can only be used to a limited extent on substrates with different absorbencies. The use of synthetic resin parquet adhesives containing solvent as per DIN 14 293 is no longer restricted in accordance with TRGS 610.

Since all adhesive systems containing solvent and water affect the swell tendency of wood and bamboo, they can only be used with highly absorbent substrates.

A safe alternative we would recommend is one of the modern hybrid, SMP or polyurethane parquet adhesives. Since they are solvent and water-free, they do not add moisture and are an economical solution for full-surface parquet gluing on all the usual subfloors.

2 | Floating floor installation

To float bambeau® 3SF Solid, you need an all-over even underlay.

You must lay a suitable underlay on the subfloor, combined with a polyethylene vapour barrier, which must be run up the walls above the height of the skirting board. Lay out the individual sheets so they overlap; stick the entire length of the joints with adhesive tape. On top of that, lay the footstep sound insulation, such as cork, polyethylene foam, felt.

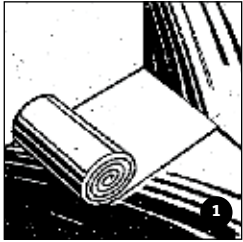

→ Figure 1

Products that combine a PE film at least 0.2 mm thick, on which 2 mm PE foam by way of sound insulation is laminated, have proved highly effective. The excess film is cut off above the skirting board after the latter is mounted.

Wooden subfloors

The strength of old plank or chipboard floors must be tested, and upgraded if necessary.

Any uneven spots must be extensively sanded. As a rule, lay the parquet elements lengthwise towards the light source. However, if you are laying them directly on an old plank floor, you must lay the elements perpendicular to the planks. Wooden subfloors may also be levelled with chipboard. The thickness of the chipboard depends on the unevenness to be levelled out. The screws should be positioned at least 10 cm from the edge. The screws should not be more than 30 cm apart. Make sure you use countersunk head screws, which are countersunk flush with the surface after fixing.

When laying chipboard, leave a clearance of 10 mm from permanent fixtures.

FITTING AT DOORS

The door frames can be shortened by the thickness of the parquet blocks! First lay a section of the parquet board on the prepared substrate. Use this parquet section as a height reference. Cut into the door frame at the correct height using an all-purpose saw. During installation, the cut-to-size prefinished parquet element can be shoved under the door frame. Do not shorten door panels until the parquet floor has been installed.

They must be shortened to allow the floor to move minutely with slight fluctuations in temperature and humidity. This is why the parquet must have a clearance of 10 mm from all permanent fixtures like: walls, pillars and radiator pipes.

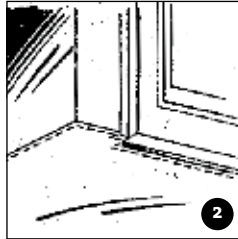

→ Figure 2

Allow for expansion joints in the surface for parquet spaces greater than 6 m in length and 6 m in width. In such cases,

have a clearance of 13 mm from walls and all permanent fixtures. The parquet should be kept in the room where it will be laid in its original, unopened packaging for at least 48 hours before installation, to give it time to acclimatise. The packaging must be stored horizontally and completely flat. The room where the parquet flooring is to be laid must be dry; the dryness of the subfloors must be checked if necessary. The parquet boards must be laid at a room temperature of at least 15°C and at most 22°C. The relative humidity in the room should be between 50% and 65% (use a hygrometer to check). These ambient conditions should be maintained after installation as well.

Constant ambient conditions prevent gaps from forming. If conditions differ greatly from the above, low humidity can cause gaps and high humidity can cause expansion.

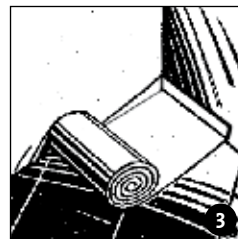

[1] After the substrate has been properly prepared, the parquet underlay must be laid as described in the "Screeds" section. → Figure 3



[2] Begin installation at a straight wall with the groove facing the wall. Make sure that the first row you lay is aligned absolutely straight; this is the only way to ensure that the rest of the parquet elements are laid without gaps. This is easy to check by spanning a plumb line along

the installed elements. We recommend you lay the floorboards lengthwise towards the light source. → Figure 4

[3] Allow for a clearance of 10 mm from all permanent fixtures (including heating pipes) for rooms no bigger than 6 m x 6 m. With larger rooms, a clearance of 13 mm and expansion joints must be

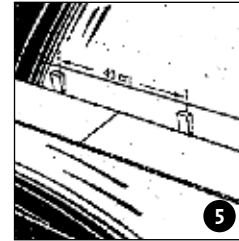

left, which reduce the continuous parquet area. Insert wedges into the parquet elements every 40 cm to prevent the individual elements from slipping when tongue-and-grooving.

→ Figure 5

Caution! Remove the wedges 24 hours after finishing installation.

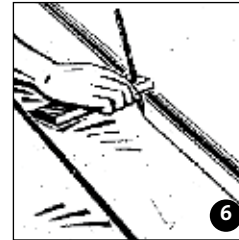

[4] If the walls are uneven, work the unevenness into the parquet element. Fix a pencil to a spacer and trace the uneven lines onto the parquet element.

→ Figure 6

Saw out along the line and wedge the shaped element back into its place. Remember the clearance! Use saws designed for sawing wood.

[5] To glue the tongue-and-groove joint, use a standard commercial waterproof white glue (PVAC D3). The entire length of the top of the tongue and

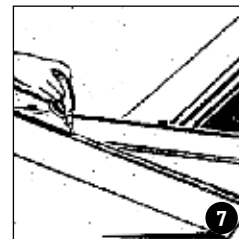

the face of the element must be glued. If you are having difficulty tongue-and-grooving the elements, the reason for it may be that too much glue was applied.

→ Figure 7

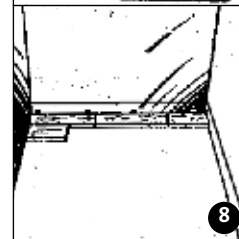

[6] Use the cut-off from the last row to begin the next row; apply the glue all round the tongue. The space between the head joints must be at least 40 cm.

→ Figure 8

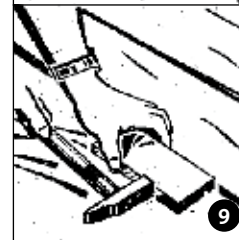

Always tongue-and-groove the elements using a 30 to 40 cm-long chock; never hit the tongues directly with the hammer.

→ Figure 9

Glue coming out at the joint must be removed immediately with a slightly moistened cloth. Do not leave any residue. You need around 500 g glue for 15 m².

[7] When installing the last row, lay the element with the groove to the wall. Measure the distance to the last element you have laid (penultimate row).

Take into account any unevenness in the wall, and the requisite clearance. If the parquet element has been cut to size: apply glue, fit and wedge.

→ Figure 10

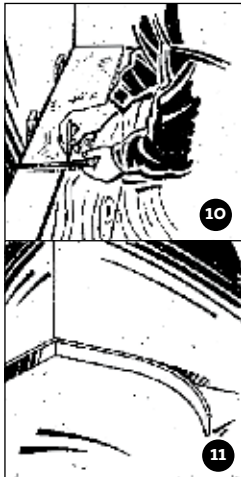

The clearance must be maintained around heating pipes as well.

[8] Skirting boards must be mounted on the wall but must not be fixed to the parquet flooring, so the parquet can move under the skirting board.

→ Figure 11

Once the skirting board is fastened, the excess film can be cut off with a knife.

3 | Installation on hot water underfloor heating

If you are planning this type of installation, be sure to consult with Becker & Großgarten GmbH to clarify details of procedure and materials.

AFTER INSTALLATION

The glue must be given 12 hours to dry before stepping on the parquet flooring. The wedges must be removed 24 hours after installation; cover visible expansion gaps with transition strips.

Important! Please follow the relevant care instructions for lacquered or oiled finishes

Caution! Never wet-wipe the parquet surface; water can get in at the joints and cause damage. Before using the parquet floor for the first time, you must treat it. This protects the finish and the joints from infiltration of moisture.

Heavy-duty cleaning and the level of care required depends on how high-traffic the parquet surface is. Living, dining and bedrooms: every 4 – 8 weeks, more heavily used parquet areas such as offices, hallways or kitchens must be thoroughly cleaned every 2 – 3 weeks.

Factory-UV-lacquering is not suitable for use in high-traffic buildings!!!

→ Please follow the »Care instructions« chapter overleaf!

NOTE

bambeau® bamboo parquet is a natural product. Colour variation in the parquet elements is typical and is caused by location-specific lignification of the raw material. Use elements from several packs at the same time to achieve the most uniform overall scheme in the parquet floor.

State of the art at: December 2010. Subject to change

These technical instructions do not form the basis either for a legal contract or an additional obligation under the contract of sale.

© Becker & Grossgarten GmbH, Cologne

These installation instructions are protected by copyright law. Any form of publication, even in part, requires the consent of Becker & Grossgarten GmbH. Violations will be prosecuted under Competition and/or Media Law.

BASIC INFORMATION ON PARQUET FLOORING CARE

Like all structural elements made of wood, wooden floors react to moisture. To prevent the wood from swelling or shrinking, please make sure that the ambient conditions are healthy and as constant as possible. The optimal conditions are: a temperature between 18°C and 22°C and a room humidity between 55 and 65%. Experience shows that these values are not nearly met during the heating period. To avoid this, we recommend you use a humidifier (evaporator) as of the beginning of the heating period. Constant ambient conditions prevent gaps from forming!

However, the durability of your floor also depends on regular and correct care.

You can use a mop, soft brush or vacuum cleaner for regular cleaning. Damp-wipe the floor; never wet-wipe it.

Stagnant moisture (puddles of water) must be removed immediately!

To protect the parquet floor, place a mat at the entrance. To prevent scratches, fit felt glides on chairs and other furniture. For swivel chairs, you need soft casters as per DIN EN 12529 and a protective mat (polycarbonate mat) placed underneath the castor surfaces.

CARE INSTRUCTIONS FOR BAMBEAU® 3SF SOLID LACQUERED

The prefinished parquet bambeau® 3SF Solid lacquered comes sealed with a high-grade UV-hardened acrylic lacquer and is thus protected from the infiltration of dirt and water.

Cleaning after installation: After completion of installation, clean the parquet floor with a mop, soft brush or vacuum cleaner, and dry. Dust and dirt have the effect of sandpaper and must therefore be removed immediately. Then clean the covering with LOBA®CareRemover diluted 1:4 and a green pad. This provides adhesion for the care product.

Initial treatment: Before using the parquet floor for the first time, we recommend you use LOBA®FloorCare matt. This protects the finish and the joints from the infiltration of moisture. Evenly apply the polish undiluted to the clean floor using the LOBATOOL-Wischwiesel. You can walk on the floor after giving it 20 – 30 minutes to dry.

CAUTION:

Never repolish the floor while it is drying!

Only use undiluted LOBA®FloorCare matt!

Regular cleaning: You can use a mop, soft brush or vacuum cleaner for regular cleaning. You can add LOBA®Cleaner to the mop water for damp cleaning. Damp-wipe the floor; never wet-wipe it. Stagnant moisture (puddles of water) must be removed immediately.

Heavy-duty cleaning: If the floor gets extremely dirty or if paths appear, old layers of polish can be removed with LOBA®CareRemover diluted 1:4 and a green pad, and then retreated with LOBA®FloorCare matt.

Product quantities:

LOBA®CareRemover	approx. 1 – 2 l/100 m ²
LOBA®FloorCare matt	approx. 3 – 4 l/100 m ²
LOBA®Cleaner	approx. 0.05 – 0.1 l/100 m ²
LOBATOOL-Wischwiesel	

CARE INSTRUCTIONS FOR BAMBEAU® 3SF SOLID OILED

The prefinished parquet bambeau® 3SF Solid oiled comes oiled with a high-grade natural oil.

Before you use the floor for the first time, we strongly recommend you use an oil care product.

Cleaning after installation: After completion of installation, clean the parquet floor with a mop, soft brush or vacuum cleaner, and dry. Dust and dirt have the effect of sandpaper and must therefore be removed immediately.

Initial treatment: After damp cleaning the covering with LOBA®Cleaner, apply a very thin layer of LOBA®ParkettOil to the dry floor. Dampen a cloth with the oil care product and skim over the floor. Remove excess product. The floor can be used after leaving it to dry overnight.

Regular cleaning: You can use a mop, soft brush or vacuum cleaner for regular cleaning. You can add LOBA®Cleaner to the mop water for damp cleaning. Damp-wipe the floor; never wet-wipe it. Stagnant moisture (puddles of water) must be removed immediately.

Regular care: Use LOBA®ParkettOil for regular care. Dampen a cloth with the oil care product and skim over the floor.

Heavy-duty cleaning: It is only necessary to thoroughly clean the floor by hand or machine if heavy dirt has adhered to it which regular cleaning does not remove. Spread LOBA®WaxRemover over parts of the floor, give it a short time to work in, and scrub it or use a cleaning machine with the green pad placed underneath it. Remove the dissolved film of wax along with the dirt while it is still wet using the cloth. The dry floor should then be retreated.

Product quantities:

LOBA®ParkettOil	approx. 1 l/100 m ²
LOBA®Cleaner	approx. 0.05 – 0.1 l/100 m ²
LOBA®WaxRemover	approx. 2 – 4 l/100 m ²

IMPORTANT NOTE

For the cleaning and care of our parquets bambeau®3SF Solid lacquered and bambeau®3SF Solid oiled, we recommend, as described opposite, you use LOBACARE® products from LOBA, which you can also purchase from us.

Always follow the separate instructions on the pack labels as well!

You can get further information on LOBACARE® products from LOBA GmbH & Co. KG, Leonbergerstr. 56 – 62, 71254 Ditzingen, Germany Tel. +49 (0)7156-357 220, Fax +49 (0)7156-357 211, E-mail: service@loba.de, www.loba.de